

## Standard Preparation 2000 mm Storage Cabinet with shelves & sliding doors

ITEM # \_\_\_\_\_

MODEL # \_\_\_\_\_

NAME # \_\_\_\_\_

SIS # \_\_\_\_\_

AIA # \_\_\_\_\_

**132802 (MAS2000SPN)**

Storage Cabinet with 3 shelves and 2 sliding doors, 2000mm

### Short Form Specification

Item No. \_\_\_\_\_

Made entirely from stainless steel. Inner welded frame in stainless steel. Unique connection of panels to inner frame. Height adjustable intermediate shelves, supports and inner doors in stainless steel. Sound-deadened sliding doors. Mounted on feet, adjustable in height.

### Main Features

- Handles in stainless steel for better hygiene and reliability.
- Sturdiness, stability and reliability of table accurately tested.

### Construction

- Reinforced side and base panel in 304 AISI stainless steel.
- Sturdy sound-deadened sliding doors on tracks located flush to the front of the frame.
- Easy access to the cupboard interior on all lengths guaranteed by the use of only 2 doors.
- 304 AISI stainless steel feet, 200 mm high and 54 mm in diameter, adjustable by -50/+30 mm.
- Equipped with three intermediate shelves, one fixed in the middle and two which can be positioned at different heights.
- Intermediate shelf in stainless steel with riveted corners and trasversal reinforcement in stainless steel.
- 100 mm upstand with 10 mm radiused corner and 13 mm deep, designed to be used against a wall.
- Base panel has 40mm high profile, is 8/10 in thickness with upturned edges and bar reinforcement. It is welded to legs for further structure reinforcement.
- Two double-walled sliding doors flush fitting to the front of the frame can be removed to facilitate cleaning of the cupboard interior.
- 304 AISI stainless steel feet, 150 mm high and 54 mm in diameter, adjustable by -35/+25 mm.

### Optional Accessories

- Wheel kit for cupboards, 4 wheels (2 with brakes), D=1000 mm PNC 855299

APPROVAL: \_\_\_\_\_

## Key Information:

<b>Cabinet width:</b>		
132802 (MAS2000SPN)	1945 mm	
<b>Cabinet depth:</b>	645 mm	
<b>Cabinet height:</b>	1797 mm	
<b>External dimensions, Width:</b>	2000 mm	
<b>External dimensions, Depth:</b>	700 mm	
<b>External dimensions, Height:</b>	2000 mm	
<b>Net weight:</b>	140 kg	

Front

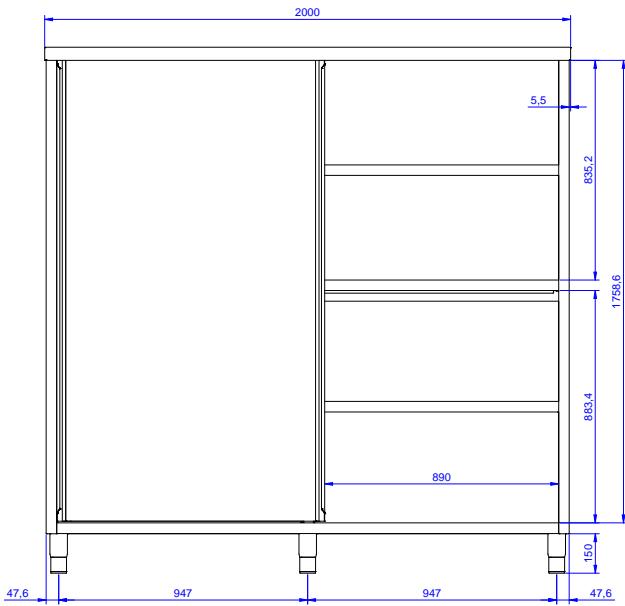

Side

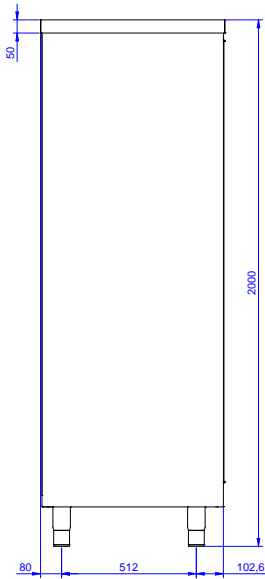

Top

